

INSTALLATION INSTRUCTIONS:

1. TWO 13070 DEVICES ARE REQUIRED PER WINDOW.
2. ROUTE OR PUNCH TWO HOLES IN THE FRAME OR UPPER SASH WITH DIMENSIONS .313" x 2.05".
3. THE WOCD FABRICATION MUST BE POSITIONED SUCH THAT THE LOWER SASH HAS A CLEAR OPENING OF 4" OR LESS AFTER BEING STOPPED BY THE WOCD DEVICES.
4. SNAP THE WOCD DEVICES INTO THE FABRICATED HOLES. NOTE THE UP/DOWN ORIENTATION IN THE IMAGE ABOVE.
5. CONFIRM THE LOWER SASH HAS A CLEAR OPENING OF 4" OR LESS AFTER BEING STOPPED BY THE WOCD DEVICES.

OPERATING INSTRUCTIONS:

1. OPEN THE SASH UNTIL IT IS STOPPED BY THE WOCD DEVICES. THE LATCHES WILL MOVE UPWARD SLIGHTLY UNDER SPRING TENSION AFTER CONTACTING THE SASH.
2. PRESS THE PROTRUDING WOCD LATCHES IN UNTIL THEY DROP BEHIND THE SASH.
3. CONTINUE OPENING THE SASH FOR CLEANING OR EGRESS PURPOSES.
4. THE WOCD DEVICES WILL AUTOMATICALLY RESET AND THE LATCHES WILL BE FULLY EXTENDED AS SHOWN IN THE DRAWING ABOVE ONCE THE SASH IS CLOSED.

RECOMMENDED FAB

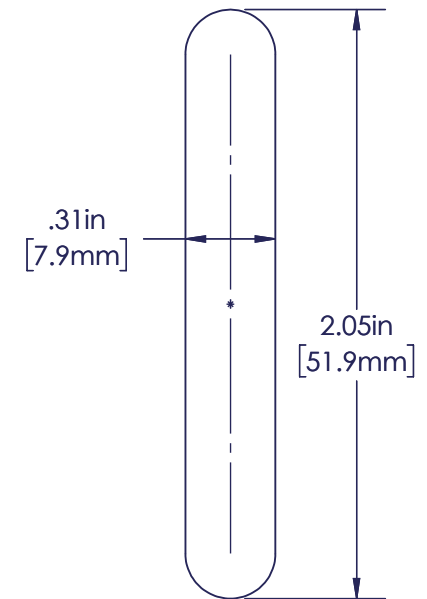

CUSTOMER PAGE



Engineered Solutions. Trusted Results.

THE INFORMATION CONTAINED IN THIS DRAWING IS CONFIDENTIAL AND PROPRIETARY. THIS DRAWING IS NOT TO BE COPIED OR REPRODUCED IN WHOLE OR IN PART WITHOUT EXPRESS WRITTEN PERMISSION.

INTERPRET PER:
ASME Y14.5M-2009

UNITS: INCH

THIRD ANGLE
PROJECTION

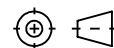

DRAWING TITLE:

WOCD

SCALE: 3:2

DRAWING #:

13070

SHEET 1 OF 1